

SHEET 1
REV 1
10101534

FIRST ANGLE PROJECTION

REVISIONS

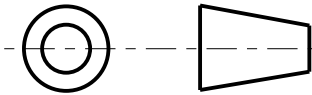

REV.	DESCRIPTION	DATE	APPROVED
1	C035056	10/24/17	SANDEEP

GE PROPRIETARY AND CONFIDENTIAL INFORMATION
 This document is the property of General Electric Company ("GE") and contains proprietary information of GE. This document is loaned on the express condition that neither it nor the information contained therein shall be disclosed to others without the express written consent of GE Energy, and that the information shall be used by the recipient only as approved expressly by GE Energy. This document shall be returned to GE upon its request. This document may be subject to certain restrictions under U.S. export control laws and regulations.

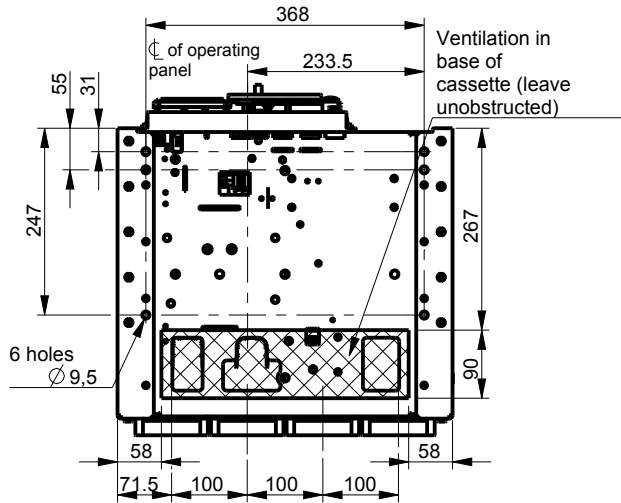

FOR TERMINATION DETAILS
 REFER 3POLE DRAWING 10101524PV1

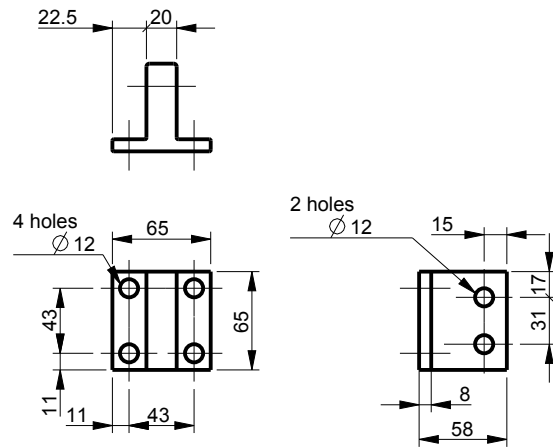
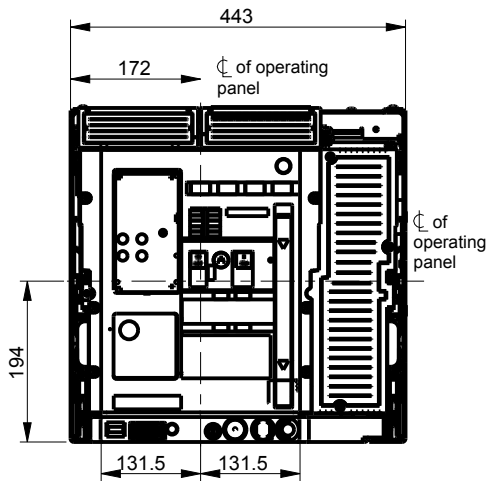

OUTLINE_IEC_TERM_F1

NOTE:
 COPPER WORK MUST BE SUPPORTED WITHIN 200 MM (7.87 INCH) OF BREAKER CONNECTIONS - BUS BAR OR CABLES
 ALL CONNECTIONS TO BE TIGHTENED TO 50NM (442.5 LB-INCH) TORQUE

Article or Material Must Conform to REACH Procedure SI900000 Sec. 14

Article or Material Must Conform to RoHS Procedure SI900000 Sec. 13

PV1

Part must conform to SI 900000 Sect. 4, Toxicity Procedure

FOR ADDITIONAL INFO REFER TO:	SIGNATURES	DATE
APPLIED PRACTICES	MODEL RAGHAV	07/13/17
DIMENSIONS ARE IN MILLIMETERS	DETAIL RAGHAV	07/13/17
UNLESS OTHERWISE SPECIFIED IN DRAWING	CHECKED SANDEEP	07/13/17
TOLERANCE ON:	ENGRG	
1 PL DECIMALS ± 0.3	MFG	
2 PL DECIMALS ± 0.13	QUALITY	
ANGLES ± 0.5	ISSUED	
FRACTIONS ±		
FINISH		
CRITICAL TO QUALITY CHARACTERISTIC	DRAWING FILE: 10101534PV1	
	SOLID MODEL: 10101534PV1	

GE Energy

TITLE: **OUTLINE CASS IEC F1 4P**

SIZE: **A4** DRAWING: **10101534** REV: **1**

SCALE: 3:10 REF. No.: SHEET 1 of 1

METRIC