

*User manual*

# ***Power Distribution Unit***

*Power Distribution Unit  
For Use with 208 Vac UPS Systems*

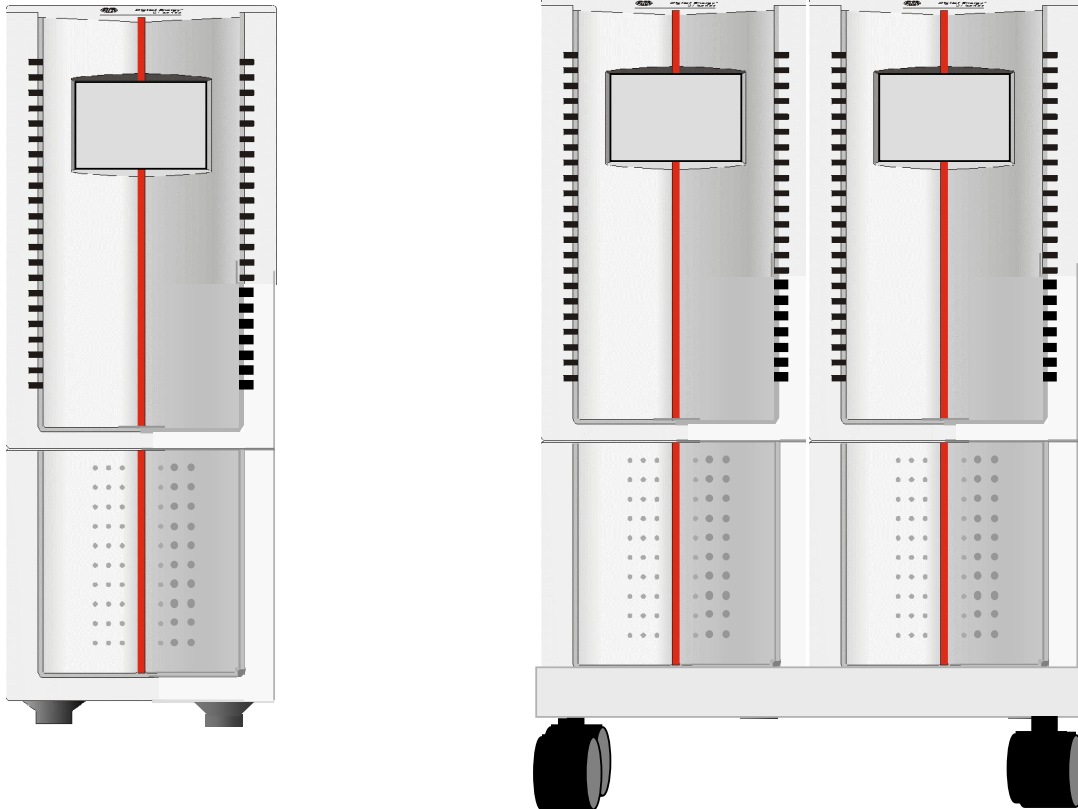

**C**  **US**  
**LISTED**  
**File#: E238017**



# USER MANUAL

## *Power Distribution Unit For Use with 208 Vac UPS Systems*

The 208V Power Distribution Unit, provides both 208VAC and 120VAC output connectivity for 208 Vac Input UPS systems.

Please keep this manual in a safe place for future reference and carefully read the important safety instructions in chapter 1 before installation and start-up of the UPS.

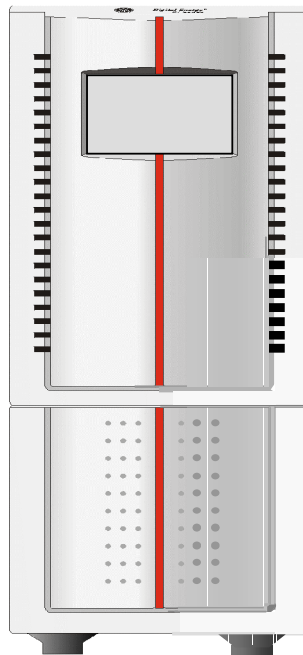

## CONTENTS

1	IMPORTANT SAFETY INSTRUCTIONS .....	3
	1.1 Save these instructions	
	1.2 General	
	1.3 Installation	
	1.4 Transportation	
2	INSTALLATION .....	4
	2.1 Package contents	
	2.2 Location	
	2.3 Rear panel	
	2.4 Installation	
	2.4.1 Reference UPS User Manual	
	2.4.2 Connecting the PDU	
3	SPECIFICATIONS .....	7

# 1 - Important Safety Instructions

## 1.1 Save these instructions

This manual contains important instructions for the **208V PDU** that should be followed during installation and maintenance of the UPS/PDU system.



**Before attempting to install and start up the UPS, carefully read this manual. Keep this manual next to the PDU for future references. All servicing must be done by qualified personnel. Do not attempt to service the PDU unless you have had proper training.**



**WARNING:** By opening or removing covers you run the risk of exposure to dangerous voltages !

## 1.2 General



- **CAUTION: RISK OF ELECTRIC SHOCK.**
- The appliance outlets may be electrically live when installed with a UPS, even when the UPS is disconnected from the utility supply. Dangerous voltages may be present during battery operation.
- Do not open the unit, there are no user serviceable parts inside.
- The appliance outlets shall be installed near the equipment and shall be easily accessible

## 1.3 Installation

- The unit should be installed by service personnel.
- To reduce the risk of electric shock, install the PDU in a temperature and humidity controlled indoor area free of conductive contaminants.
- Ambient temperature must not exceed 40°C (104°F).
- It is important that the unit has adequate ventilation. Maintain air movement around and through the unit. Do not block the air vents.
- Avoid placing the unit in direct sunlight or near heat sources.
- Avoid spilling liquids on or dropping any foreign object into the PDU.
- Do not plug a laser printer or household appliances such as electric heaters or vacuum cleaners into the PDU. The PDU output is intended to be used only for electronic loads such as computers and telecommunications equipment.
- The unit should be operated by properly trained personnel.

## 1.4 Transportation

- No liability can be accepted for any transport damage when the equipment is shipped in non-original packaging.

## 2 - Installation

### 2.1 Package contents

The packing box contains a **208V PDU**, and this manual. Carefully inspect the packing box and its contents. If any damage is visible please immediately notify the carrier and/or dealer.

### 2.2 Location

Please refer to section 1.3 of 'IMPORTANT SAFETY INSTRUCTIONS'

### 2.3 Rear panel

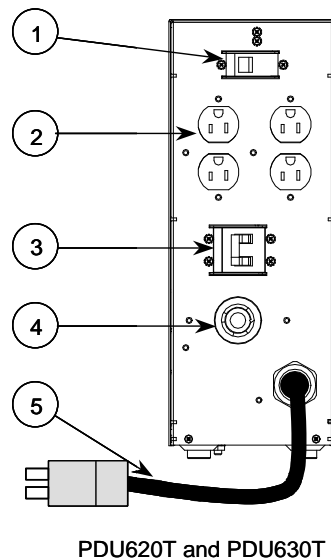

Fig. 2.1 Rear panel

- |          |  |          |  |
|----------|--|----------|--|
| <b>1</b> | <b>120VAC Output Breaker</b><br>Over-current Protection Breaker for 120VAC, L5-15 Output Receptacles (10 Amp)                            | <b>4</b> | <b>208VAC Output Receptacles</b><br>208VAC L6-xxR Output Receptacles to Connect 208VAC Load to PDU. (L6-20R Output Receptacle = 20 Amp; L6-30R Output Receptacle = 30 Amp) |
| <b>2</b> | <b>120VAC Output Receptacles</b><br>120VAC L5-15 Output Receptacles to Connect 120VAC Load to PDU  |          |  |
| <b>3</b> | <b>208VAC Input Breaker</b><br>Over-current Protection Breaker for 208VAC Input (L6-20P Input Plug = 20 Amp; L6-30P Input Plug = 30 Amp) | <b>5</b> | <b>208VAC Input Cord</b><br>208VAC L6-xxP Input Cord to Connect 208VAC Input from the UPS. (L6-20P Input Plug for L6-20 PDU; L6-30P Input Plug for L6-30 PDU)              |

## 2.4 Installation

The unit should be installed by service personnel.

**2.4.1 Before Installing the 208V PDU, reference the UPS User Manual for proper installation and operation of the UPS system.**

### 2.4.2 Connecting the PDU

1. Insure that the UPS Output is off before installing the PDU. (Remember, the UPS output may still be LIVE even when disconnected from utility power) refer to the UPS User Manual for procedure to turn off all outputs.
2. Install the PDU and UPS units on the GT Tray with the PDU on the right hand side of the UPS when facing the units. (as shown in Fig. 1 below)



#### **IMPORTANT:**

Insure that the ventilation openings on the left side of the UPS and the right side of the PDU are always open and free from obstruction.

3. Plug the PDU 208VAC input plug into the locking 208VAC output receptacle of the UPS and twist to lock. (see Fig. 1 Rear View)

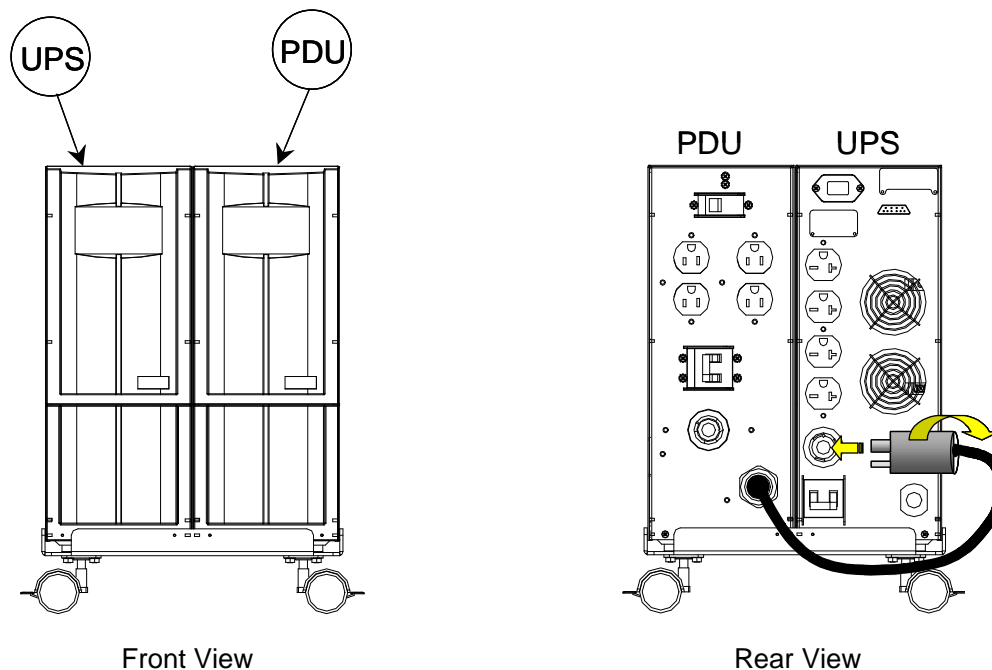

**Fig. 1**

4. Plug the equipment that you wish to power into the output receptacles of the PDU.
5. Install and power-up the UPS as instructed in the UPS User Manual supplied with the UPS system.
6. The installed UPS/PDU system should be similar to the system shown in Fig. 2.

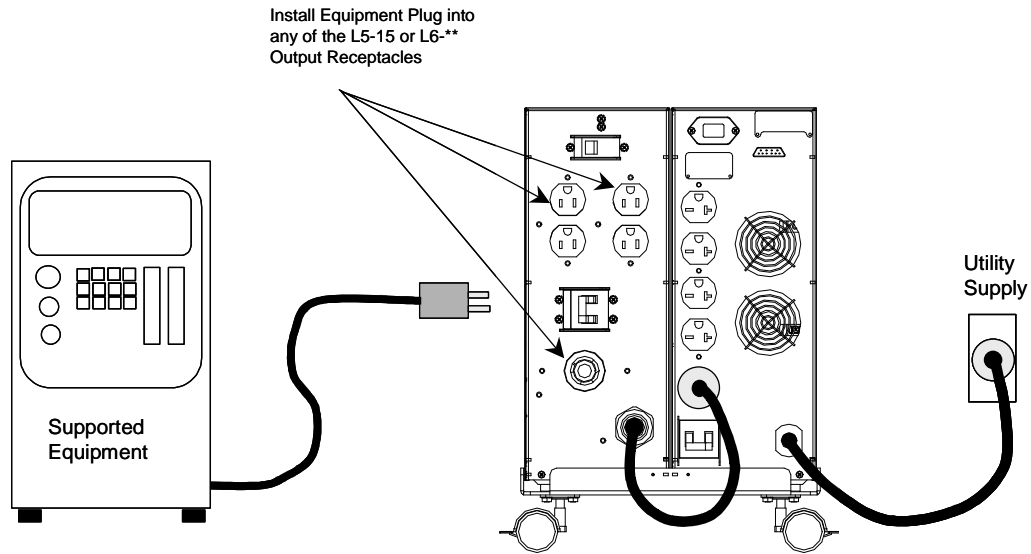
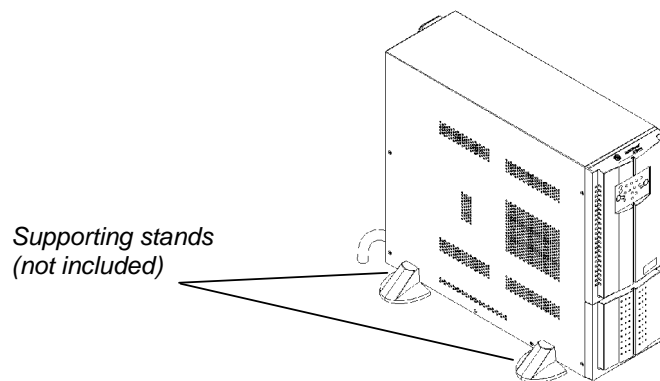

**Fig. 2**

7. The PDU now supplies both 120VAC and 208VAC outputs from the single 208VAC output of the UPS.

**NOTE:** Using the 208V PDU without the tray assembly

To secure a stable placing of the 208V PDU as a free standing unit without the GT tray assembly, it is advised to set up the PDU with supporting stands (not included in delivery) as shown:



### 3 - Specifications

PDU Model		PDU-01-112-GT	PDU-02-113-GT	PDU-03-112-GT	PDU-04-113-GT
<b>Input</b>	Rated Voltage	208VAC	208VAC	208VAC	208VAC
	Frequency	50/60 Hz	50/60 Hz	50/60 Hz	50/60 Hz
	<b>Max. Current</b>	<b>20 A</b>	<b>30A</b>	<b>20 A</b>	<b>30A</b>
	Plug Type	L6-20P	L6-30P	L6-20P	L6-30P
	Cord Length	12 in. (30.48 cm)		5 ft. (1.5 m)	
<b>Output 120VAC</b>	Voltage	120VAC	120VAC	120VAC	120VAC
	Frequency	50/60 Hz	50/60 Hz	50/60 Hz	50/60 Hz
	Max. Current	10 A (total)	10 A (total)	10 A (total)	10 A (total)
	Receptacle Type	2x 5-15 Duplex	2x 5-15 Duplex	2x 5-15 Duplex	2x 5-15 Duplex
<b>Output 208VAC</b>	Voltage	208VAC	208VAC	208VAC	208VAC
	Frequency	50/60 Hz	50/60 Hz	50/60 Hz	50/60 Hz
	Max. Current	20 A	30 A	20 A	30 A
	Receptacle Type	L6-20R	L6-30R	L6-20R	L6-30R
<b>Output Total</b>	Total Max. Current	<b>24 A</b> 14A @ 208VAC 10A @ 120VAC	<b>34 A</b> 24A @ 208VAC 10A @ 120VAC	<b>24 A</b> 14A @ 208VAC 10A @ 120VAC	<b>34 A</b> 24A @ 208VAC 10A @ 120VAC
<b>Environment</b>	Operating Temperature	0~40°C (32~104°F)			
	Humidity	0%~90% (non-condensing)			
<b>Safety Approval</b>	Safety	UL/cUL			
<b>Appearance</b>	Dimensions (W×D×H)	140x366x242 mm 5.5x14.4x9.5 inch			
	Weight	20.86 kg 46 lbs			