

3D Model is the Master Document of Record
 Article or National Model Conforms to IEC 61439-1 Procedure 5000000 Sec 1.4
 Part 1 Model Conforms to IEC 61439-1 Procedure 5000000 Sec 1.3
 Part 2 Model Conforms to IEC 61439-1 Procedure 5000000 Sec 1.2
 Geometric Dimensioning & Tolerancing as per ASME Y14.5-2009

NEMA 4 AND 12
 SAME AS 3R EXCEPT AS SHOWN

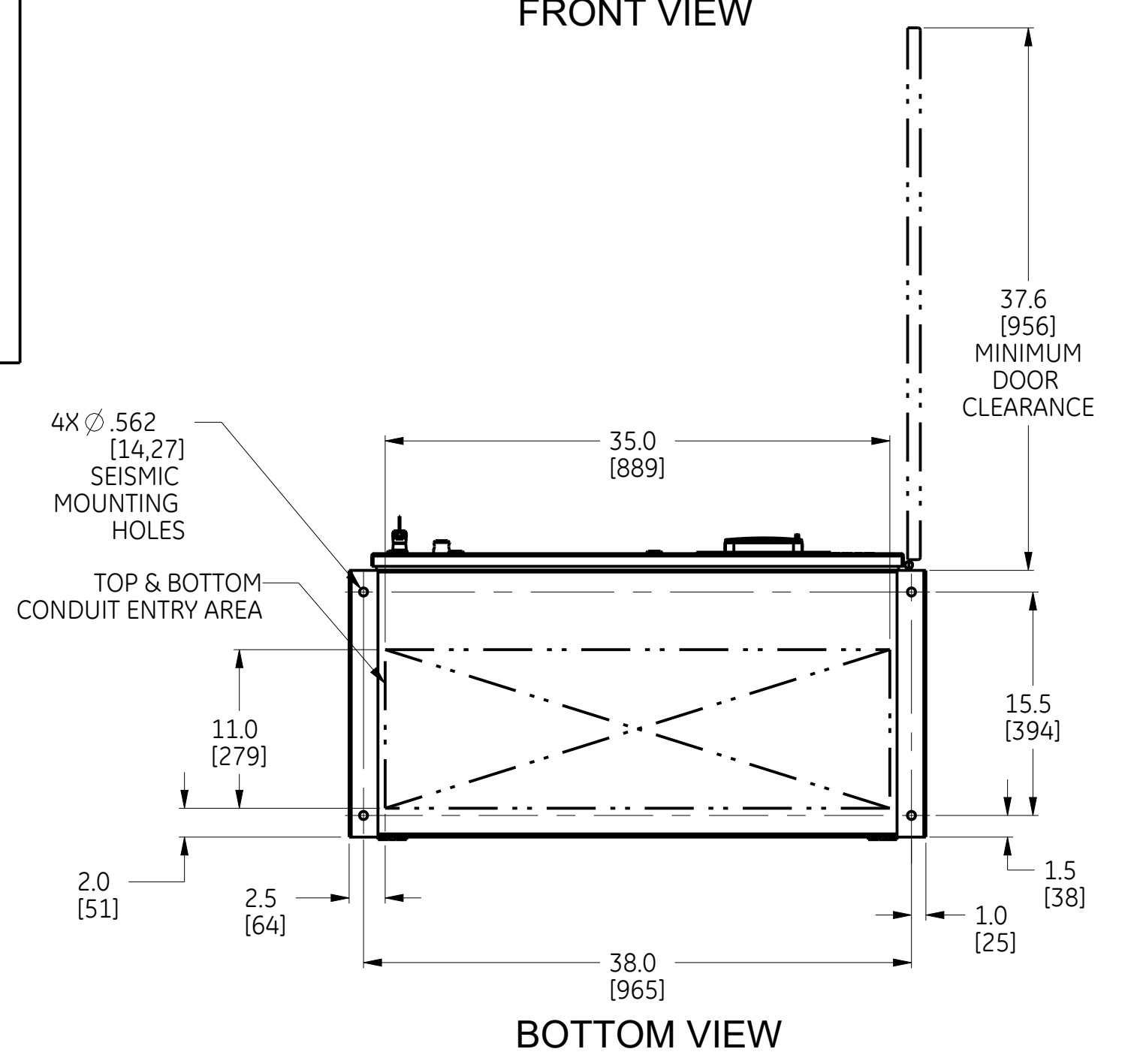
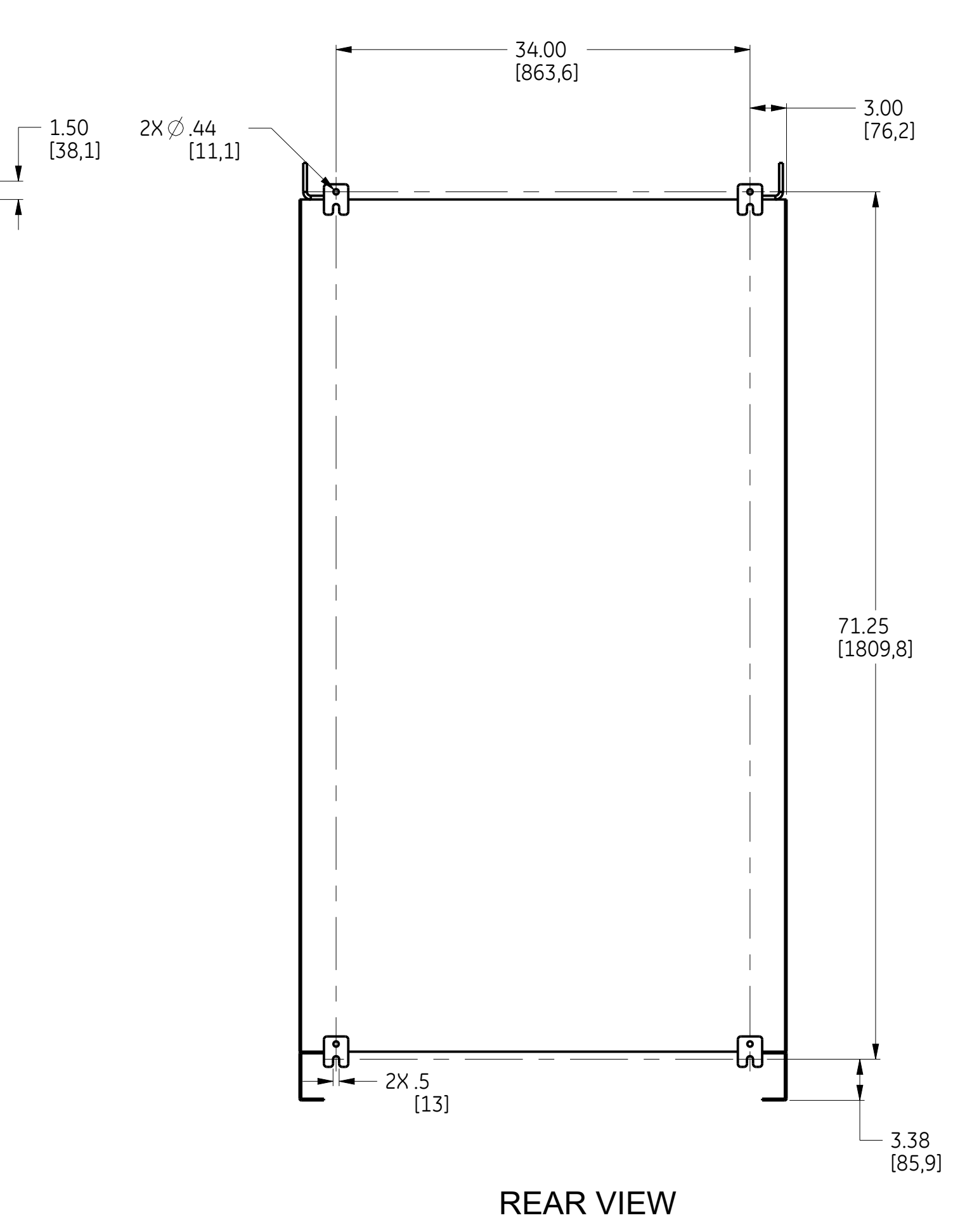
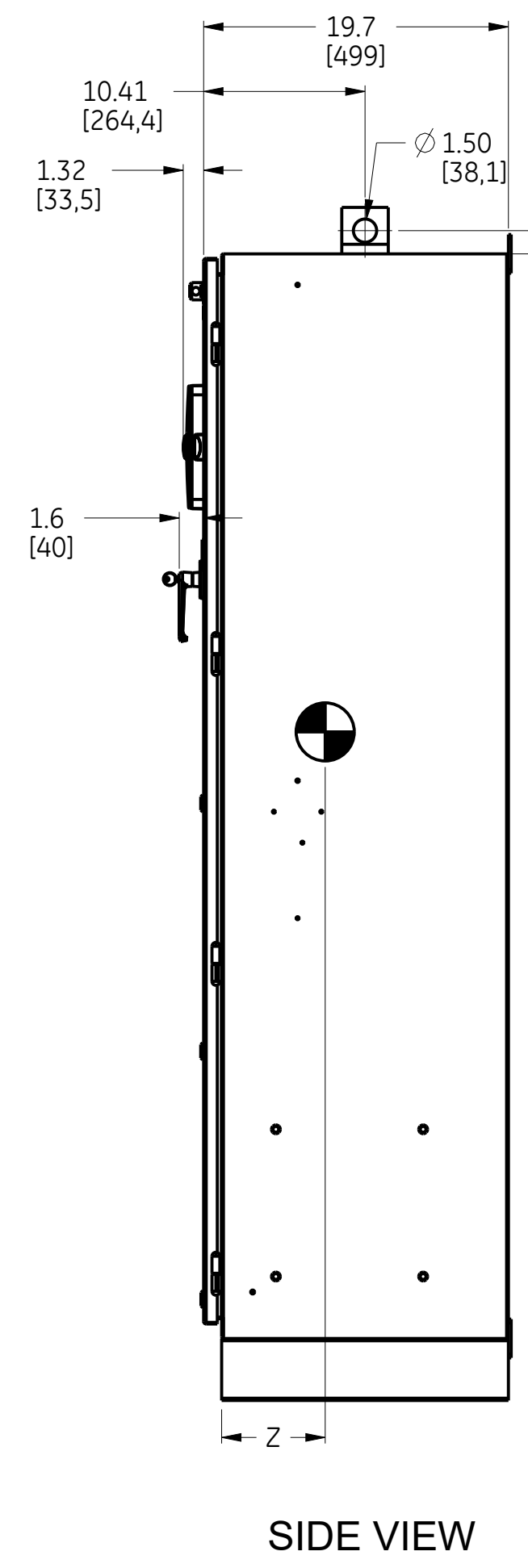
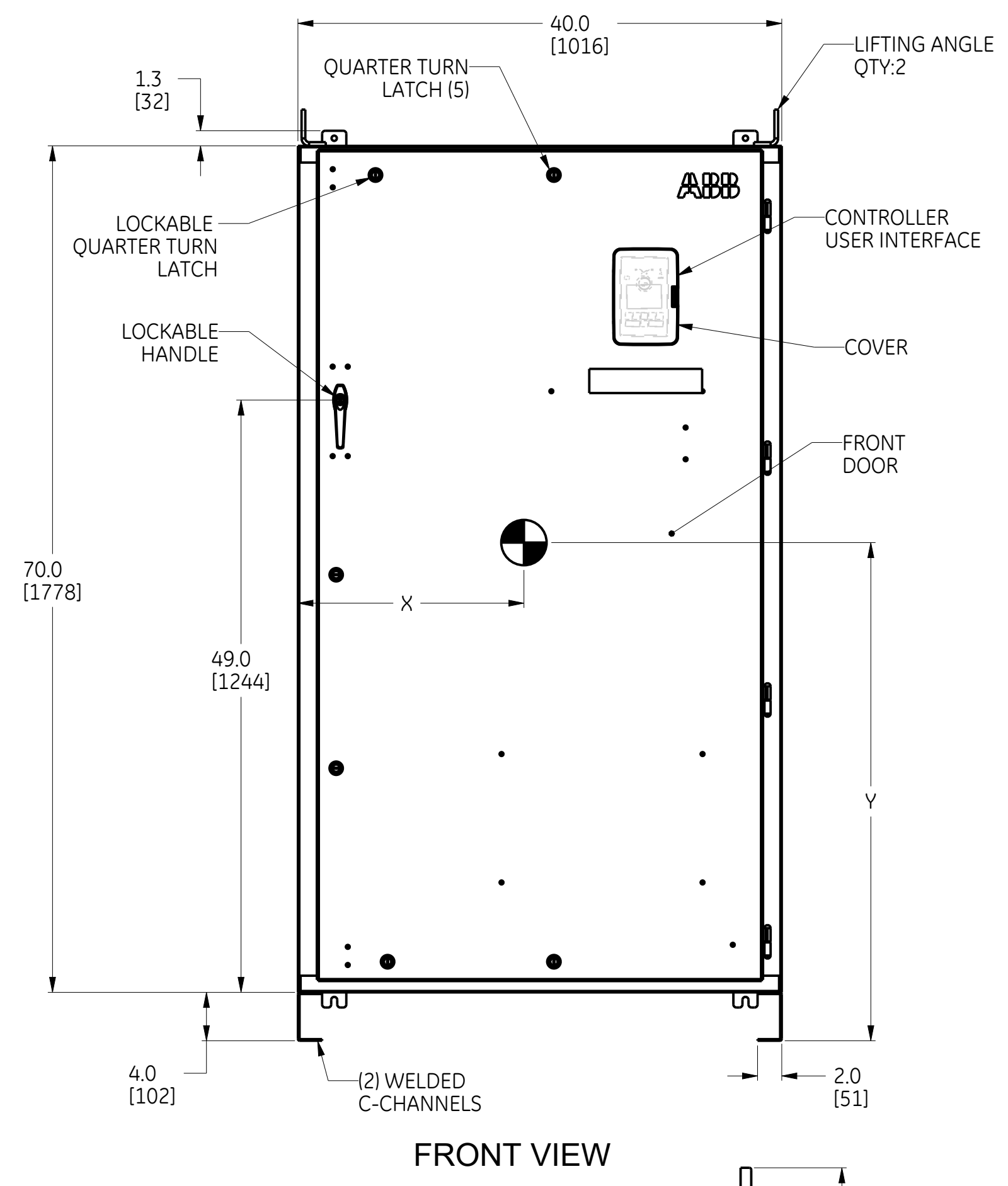
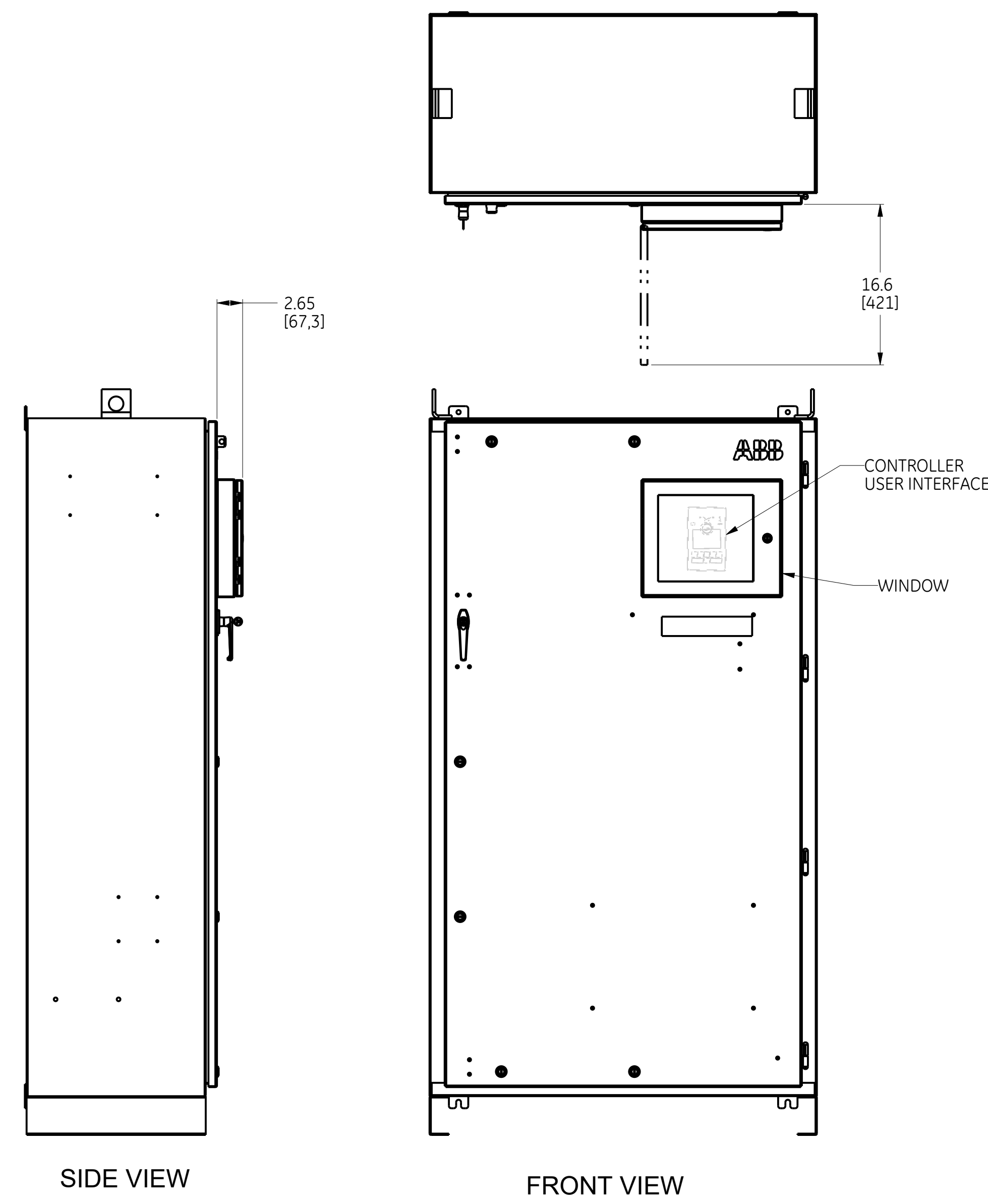

- NOTES
- ENCLOSURE : NEMA-3R,4,12 TYPE, FREE STANDING, FLOOR MOUNT.
 - MATERIAL:12 GA (.105) 1018 HRS REF.
 - FINISH : ANSI 61 GREY
 - CONSTRUCTION PER UL 1008 STANDARD.
 - FRONT ACCESSIBLE UNIT. NO SIDE OR REAR ACCESS REQUIRED.
 - SUITABLE WIRE BENDING SPACE PROVIDED PER THE SAFETY AGENCY STANDARDS.
 - UL AND CSA RECOGNIZED/CERTIFIED MECHANICAL LUGS ARE STANDARD.
 - EQUIPMENT GROUND LUG IS PROVIDED IN ALL UNITS. REFER TO SHEET 2 FOR DETAILS.
 - ALL DIMENSIONS ARE FOR REFERENCE ONLY AND SHOWN IN INCHES(MILLIMETERS).
 - 100% RATED SOLID/SWITCHED NEUTRAL PROVIDED PER THE SWITCH CONFIGURATION.
 - SUITABLE FOR TOP AND/OR BOTTOM CABLE ENTRY.

- SEISMIC NOTES:
- BOLT ENCLOSURE FROM C-CHANNEL BASE USING THE FOLLOWING SEISMIC CERTIFIED MOUNTING HARDWARE PER MOUNTING HOLE: (HARDWARE PROVIDED BY INSTALLER).
 *1/2-13 GRADE 5 BOLT TORQUE TO 70 FT-LBS. (95 NEWTON METERS).
 *1/2-13 STANDARD FLAT WASHER.
 *1/2 (13) HELICAL SPRING LOCK WASHER.
 - CENTER OF GRAVITY DIMENSIONS ARE FOR REFERENCE ONLY.
 - FOR WORKING CLEARANCE REFER TO NATIONAL AND LOCAL CODES AND STANDARDS.

AMP	POLE	CONTROLLER TYPE	CABINET #	LUG RANGE	WEIGHT LB(KG)	CENTER OF GRAVITY IN(MM)		
						X	Y	Z
800A-1200A	3	SEE TABLE A	F-2017MP	QTY 4 2 AWG-600 KCMIL	516(234)	20.4	38.6	9.6
	4				550(249)	(518)	(980)	(244)

TABLE A - HMI

TYPE	TRANSITION	LEVEL	PART NO.
ZTX	OPEN	2	OXAMI1-L2
ZTG	OPEN	3	OXAMI1-L3
ZTGD	DELAYED	3	OXBMI1-L3

DRAWING FILE		MODEL FILE		ABB		
50C-1070		50C-1070				
DATE MODIFIED		DESIGNED BY		TITLE		
11-Apr-19 03:12:59 PM		DV				
VOLUME		APPROVED BY		TruONE LAYOUT, 800A/1200A NEMA 3R, 4, 12		
0.000 in^3		SR				
MASS		MATERIAL SPECIFICATION		UNITS		
0.000 lbm		Critical to Quality Characteristic				
TOLERANCE ON:		FINISH SPECIFICATION		LOCAL TITLE		
1 PL DECIMALS ± 0.1		---				
2 PL DECIMALS ± 0.02		---		SCALE		
3 PL DECIMALS ± 0.005		---				
ANGLE ± 1.0		---		PRODUCT LINE		
---		---				
Third Angle Projection		SCALE		13:100		
---		---				
---		---		ROOT NUMBER		
---		---				
---		---		REV		
---		---				
---		---		RELEASE STATE		
---		---				
---		---		1		
---		---				
---		---		In Work		
---		---				
---		---		SHEET		
---		---				
---		---		1 of 2		
---		---				

ABB PROPRIETARY AND CONFIDENTIAL INFORMATION
 The information contained in this document has to be kept strictly confidential.
 Any unauthorized use, disclosure, or distribution of this information is strictly forbidden.
 Copyright © 2018 ABB. All rights reserved.

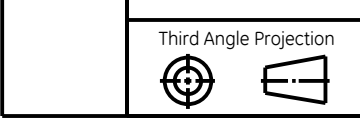

28 27 26 25 24 23 22 21

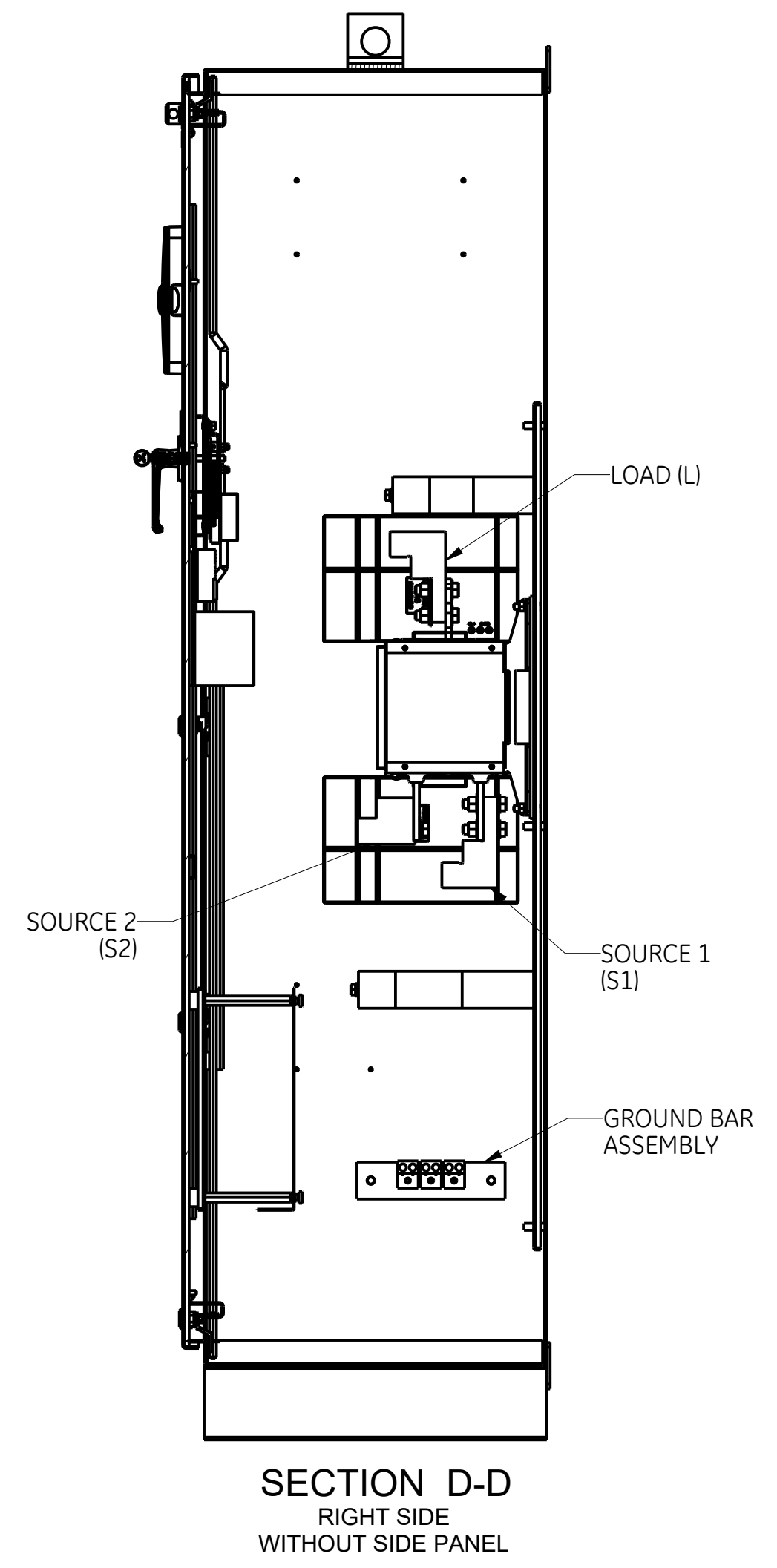
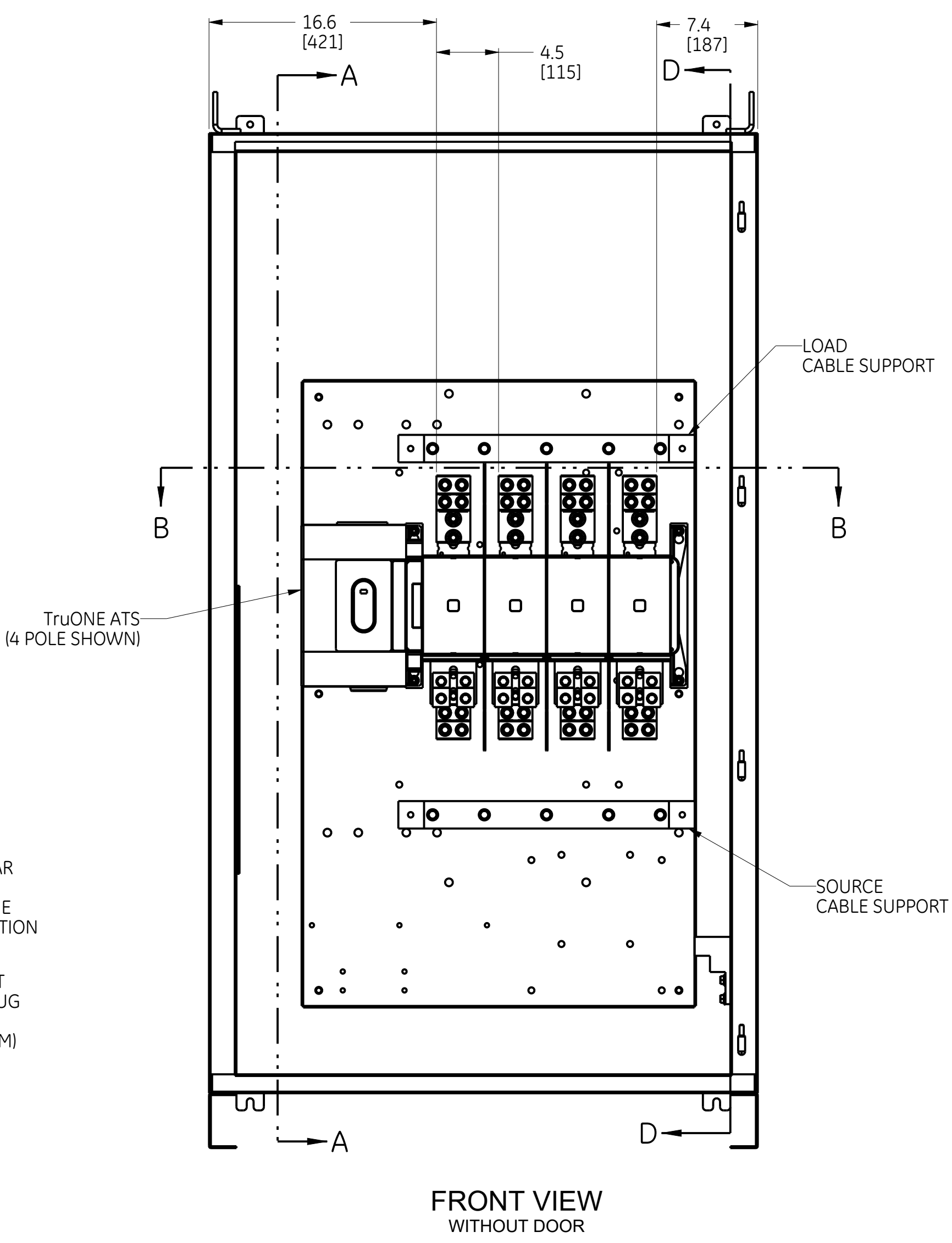
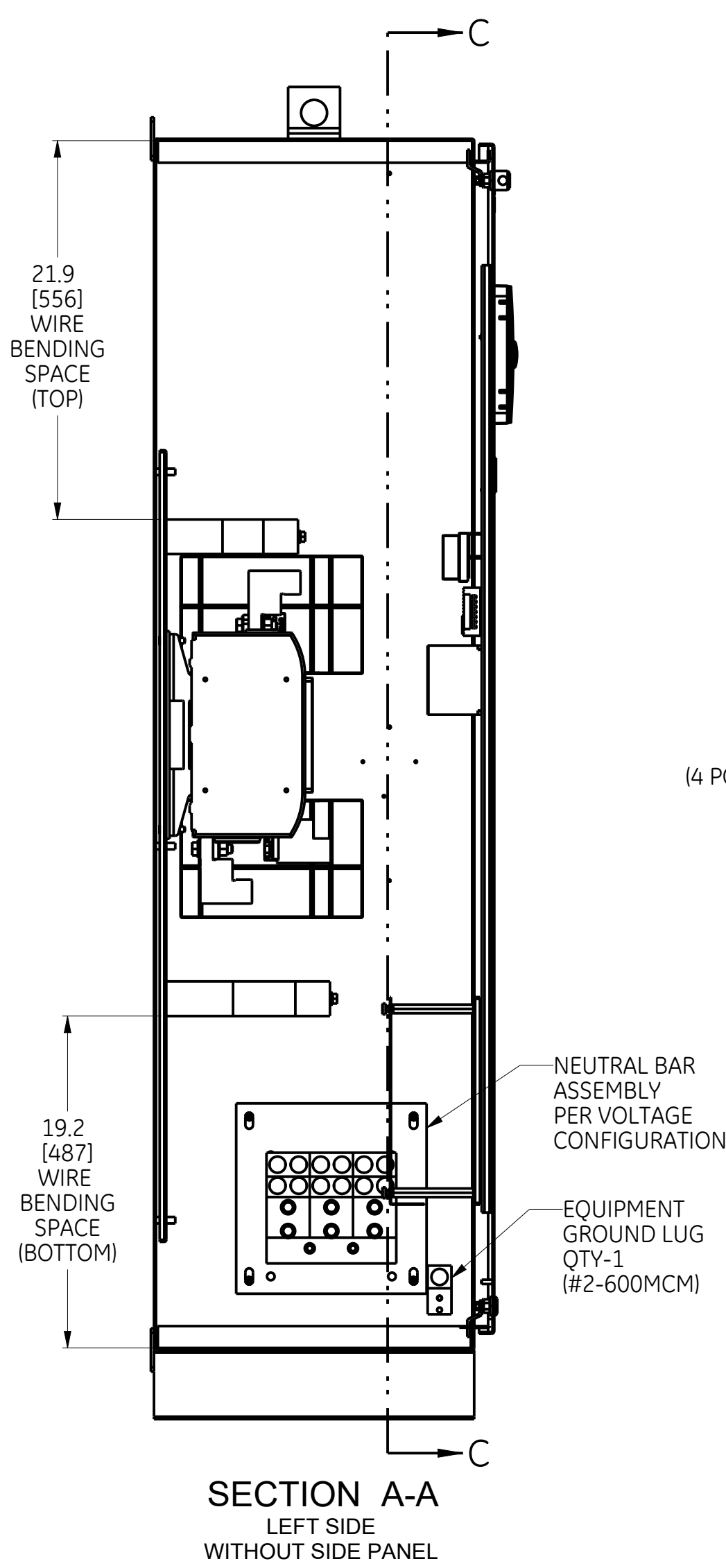
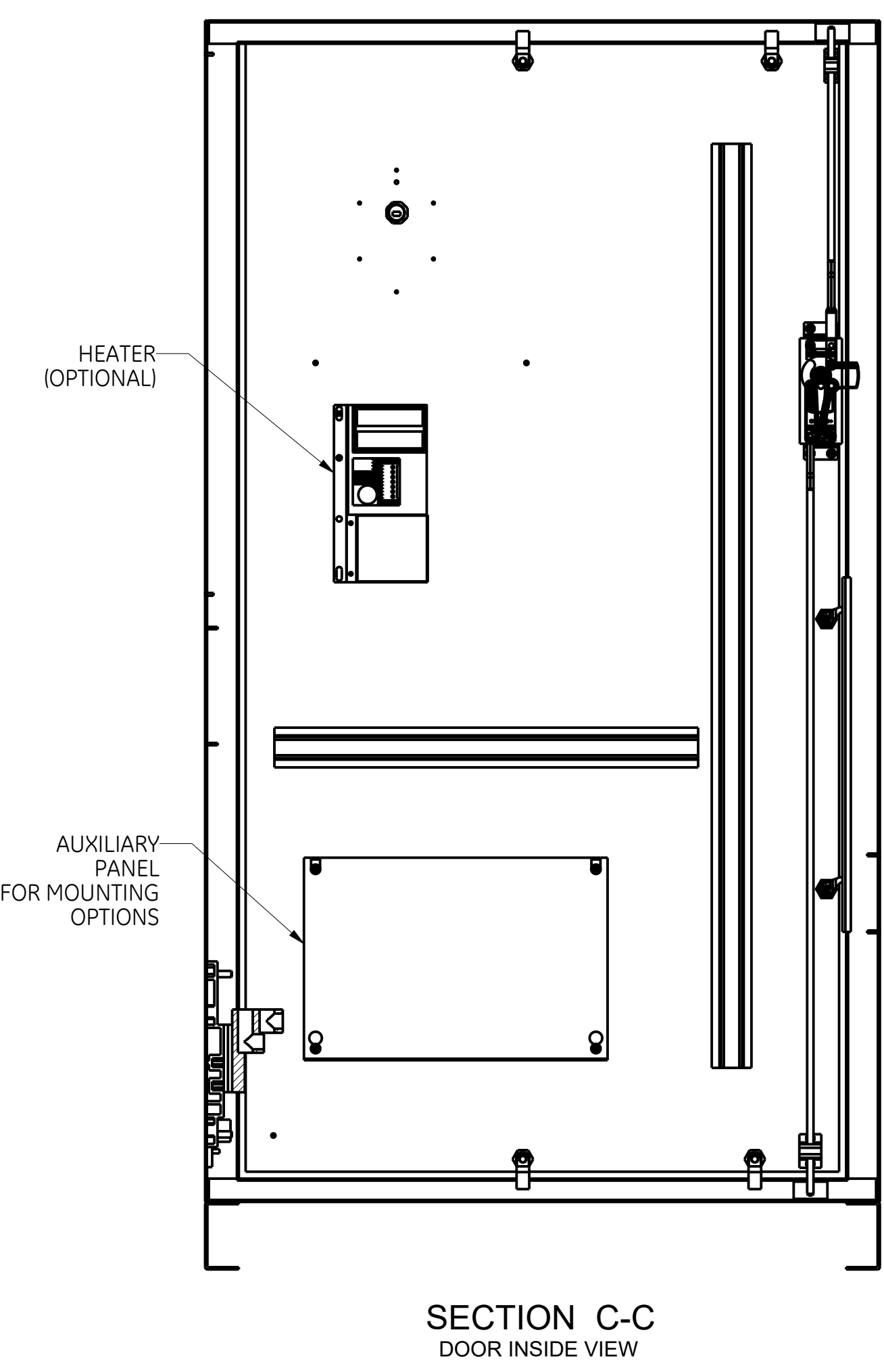
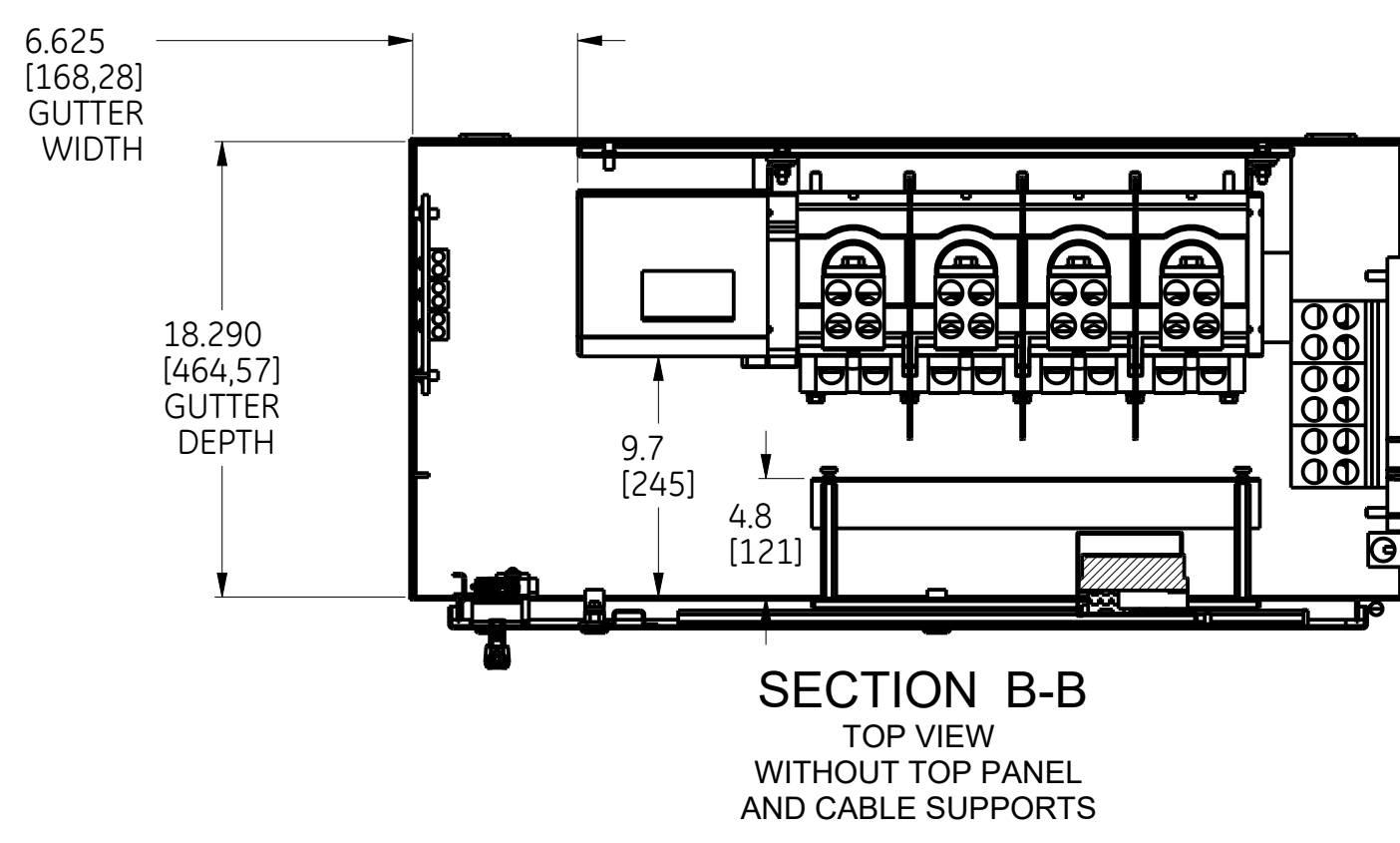

NOTE:
1. REFER TO SHEET (1) FOR COMPLETE NOTE DETAILS
2. MECHANICAL LUGS SHOWN IN ABOVE VIEWS ARE FOR REFERENCE ONLY.

ABB PROPRIETARY AND CONFIDENTIAL INFORMATION
The information contained in this document has to be kept strictly confidential.
Any unauthorized use, reproduction, distribution or disclosure to third parties is strictly forbidden.
ABB reserves the right to change specifications without notice.
Copyright © 2018 ABB. All rights reserved.

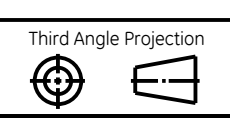

ABB		
SIZE	NUMBER	REV
D	50C-1070	1
SCALE	PRODUCT LINE	SHEET
13:100	ZTX/ZTG(D)	2 of 2

28 27 26 25 24 23 22 21